

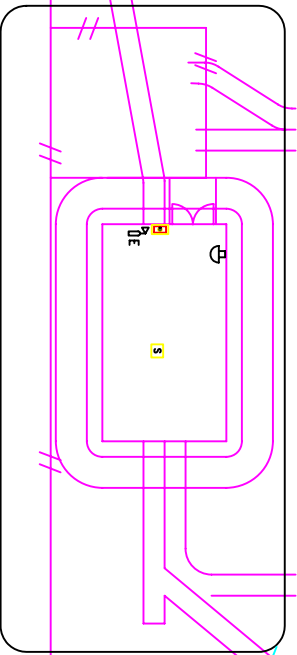

POWER STATION

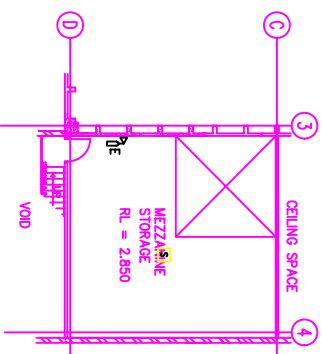

NEW SWITCHING STATION



MEZZANINE

- LEGEND**
- FIRE RATED WALL
 - 20 lb. CO₂ FIRE EXTINGUISHER
 - WEATHER PROOF LOCKABLE CABINETS WITH BREAK GLASS ACCESS PANELS
 - MANUAL CALL POINT WITH BREAK GLASS WINDOW
 - PROVIDE SMOKE DETECTION IN THESE AREAS.
 - U/V/R COMBINATION DETECTOR
 - STROBE FIRE ALARM LIGHT
 - SIREN
 - BELL

- NOTES**
1. PROVIDE FIRE ALARM BELLS IN ALL AREAS EXCEPT GENERATOR ROOM.
 2. PROVIDE SIRENS IN GENERATOR ROOM NEXT TO STROBE ALARM LIGHTS.
 3. THE ALARM SIGNAL FROM GENERATION STATION No. 2 TO SOUND FIRE ALARM AT GENERATION STATION No. 1. AMBUSHOOR PANEL.
 4. PROVIDE TWO AUTO/ANLYT ROTARY SIRENS, WIND UP PROTECTION FROM STROBE LIGHTS AND SIRENS. THE FIRE USE ONLY. LABEL ONE SIREN "ALL VENTILATION SHUT OFF" AND THE OTHER "ALL VENTILATION ON". THE SIRENS SHALL BE CONNECTED TO THE GENERATOR SERVICES CONTRIBUTOR BELL SIGNALS TO THE SIRENS.

D	1009/063A 3/28	28-112-88
C	REVISED	27-111-88
B	REVISED	4-8-88
A	CONSTRUCTION ISSUE	21-5-88
0	PRELIMINARY	9-2-87
NO.	DESCRIPTION	DATE

DESIGNED BY	REVISIONS	DATE
DRAWN BY	APPROVED	DATE
CHECKED BY	DATE	
DATE REVISED		

WORLDWIDE CONSULTANTS LIMITED
CONSULTANTS
 P.O. BOX 4887, MARSHALL ISLANDS, P.O. BOX 5000

MARSHALLS ENERGY COMPANY, INC.

MACCONNELL DOWELL CONSTRUCTORS LIMITED

PROPOSED 12 MW DIESEL POWER STATION MAJURDI MARSHALL ISLANDS

SHEET TITLE
 FIRE PROTECTION SERVICES LAYOUT