

PARTS LIST

DIMENSIONS IN MILLIMETRES
(INCHES IN BRACKETS)

IF IN DOUBT ASK
THIRD ANGLE PROJECTION

DRG. No.	D/INS 2715
ISSUE	CHANGE
0	AS DRAWN
1	MODULE NO 1 POINT 7, REVISED. SPEED SW, HEATER & AC ISOLATORS LOCATION ADDED. ITEM 11, NOTE REVISED. INTERCUBICLE BOLT FIXINGS ADDED. PRESSURE RATINGS ADDED TO MODULE 5. PAINT FINISH ADDED.
2	ITEM 6-20, DESCRIPTOR REV. MOD. 2 DESCRIPTOR REV.
3	LOCAL / REMOTE SW. ADDED. 5/5/81
4	SOURCE TAG NO'S ADDED. MOD. 2, TURBO INLETS ADDED. DESCRIPTIONS REV. MOD. 5 & 7. ALARM 19 ADDED. IND NO 15 ADDED. DISTRIB SW'S 1-2 POS'N CHANGE. 12/5/81
5	MOD. 5, ITEM'S 3, 4, 8, 5, GAUGE RANGES WERE 100 & 60. A.P.E. CROSSLEY LABEL ADDED. SWITCH POS'S ADDED TO MODULE 2. DESCRIPTION MODIFICATION NO 7, MODULE NO 8 ALTERED TO ENDO. ITEMS 5, 6 & 7 (PUSH BUTTONS) LABELLED WITH ESCUTCHION PLATES. PANEL IDENTIFICATION WAS NOT SHOWN ON BACK OF PANEL. 11/6/81
6	RFO/DFO SWITCH WAS RESIDUAL (DISTILLATE FUEL LABEL ADDED TO MODULE NO 1. AIR MANIFOLD PRESS. L.H./R.H. BANKS WERE TURBOCHARGER BOOST. AIR R/B BANKS. SEA WATER PRESS. WAS RAW WATER PRESS. LOWEST SWITCH HEIGHT WAS 736 (29). 25/6/81
7	AS MADE. 2/9/81
8	AS MADE. 2/9/81
9	MODULE 5 TAG NO. REVISED. ITEMS 1 & 2, MODULE 2, SWITCH POSITIONS 11 & 12 WERE "EXHAUST GAS INLET...". ESTIMATED NET WEIGHT OF PANEL WAS APPROX. 390 kg. 9/7/81

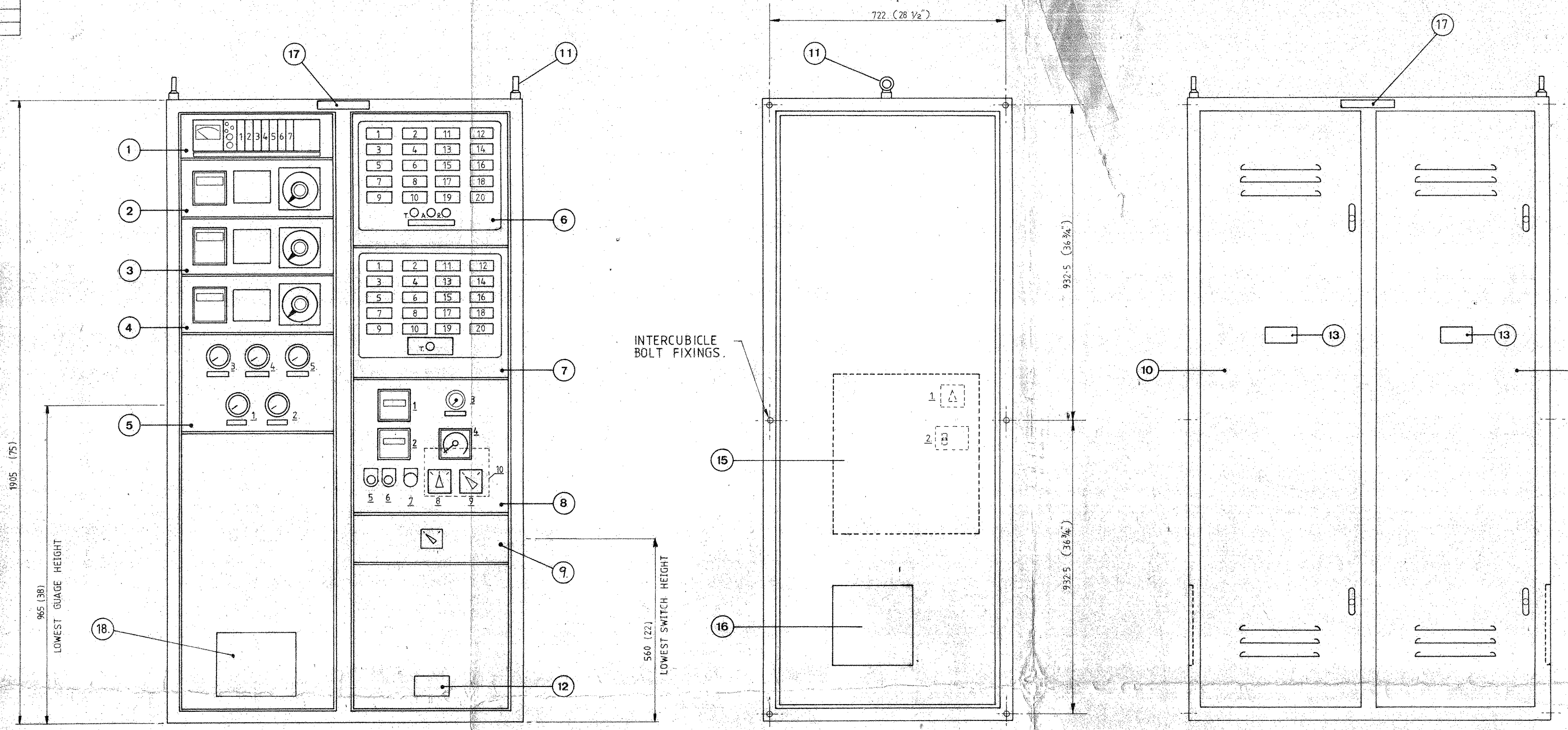

1. 5 1/4" MODULE CONTAINING:-
MAIN BEARING TEMPERATURE MONITORING SYSTEM

1. MAIN BEARING NO. 1. (8T1)
2. " " " 2. (8T2)
3. " " " 3. (8T3)
4. " " " 4. (8T4)
5. " " " 5. (8T5)
6. " " " 6. (8T6)
7. ANCHOR BEARING. (8T7)

2. 7" MODULE CONTAINING:-
EXHAUST GAS TEMPERATURE INDICATOR,
DIGITAL DISPLAY 0-600°C

- 24 POINT 2 POLE SELECTOR SWITCH
EXHAUST GAS CYL. NO. 1-10. (9T5-9T14) SWITCH POS. 1-10
----- OUTLET RH. TURBOCHARGER (9T25) SWITCH POS. 11
----- LH. TURBOCHARGER (9T26) SWITCH POS. 12
INLET RH. TURBOCHARGER (9T36). INLET LH. TURBOCHARGER (9T37) SWITCH POS. 13 & 14
RESPECTIVELY

3. 7" MODULE CONTAINING:-
ENGINE SERVICES TEMPERATURE INDICATOR
DIGITAL DISPLAY 0-200°C

- 11 POINT 3 POLE SELECTOR SWITCH
- | | |
|----------------------------|----------|
| 1. FUEL OIL (1T2) | 7. SPARE |
| 2. JACKET WATER (4T2) | 8. " |
| 3. SEA WATER (6T1) | 9. " |
| 4. LUB OIL (3T1) | 10. " |
| 5. L.H. AIR MANIFOLD (9T1) | 11. " |
| 6. R.H. AIR MANIFOLD (9T3) | |

4. 7" MODULE CONTAINING:-
ALTERNATOR STATOR WINDING TEMPERATURE
INDICATOR, DIGITAL DISPLAY 0-200°C

- 11 POINT 3-POLE SELECTOR SWITCH
- | | |
|---------------------------------|---------------------------------|
| 1. STATOR WINDING NO. 1. (9T27) | 4. STATOR WINDING NO. 4. (9T30) |
| 2. " " " 2. (9T28) | 5. " " " 5. (9T31) |
| 3. " " " 3. (9T29) | 6. " " " 6. (9T32) |

5. 12 1/4" MODULE CONTAINING:-
3" DIAL PRESSURE GAUGES, DUAL SCALED

- | | | | |
|----------------------------------|--------------------------|------------------------|-------|
| 1. AIR MANIFOLD PRESS. L.H. BANK | 0-30 lb/in ² | 0-2 kg/cm ² | (9P3) |
| 2. AIR MANIFOLD PRESS. R.H. BANK | 0-30 lb/in ² | 0-2 kg/cm ² | (9P1) |
| 3. ENGINE LUB OIL PRESS. | 0-160 lb/in ² | 0-7 kg/cm ² | (3P5) |
| 4. JACKET WATER PRESS. | 0-100 lb/in ² | 0-4 kg/cm ² | (4P2) |
| 5. SEA WATER PRESS. | 0-100 lb/in ² | 0-4 kg/cm ² | (6P2) |
- EACH GAUGE FITTED WITH AN ISOLATING VALVE AND SNUBBER.

6. 15 3/4" MODULE CONTAINING:-
20 HAZARD ALARM ANNUCIATOR FOR THE FOLLOWING CONDITIONS:-
SEE DRAWING D/ETS 2715 SH'T 3 FOR LAMP COLOURS.

- | | |
|--------------------------------------|---|
| 1. AUTO TRIP TO DFO (1P6) | 11. INJ. WATER TANK LEVEL LOW (5L2) |
| 2. FUEL PRESSURE LOW (1P7) | 12. BEARING TEMPERATURE HIGH (8T1-7)&(9T33) |
| 3. FUEL TEMPERATURE HIGH (1T4) | 13. ENGINE OVERSPEED (8S2) |
| 4. FUEL VISCOSITY HIGH (1V1) | 14. SEPERATE L.O. PRESS. LOW (10P3) |
| 5. E.L.O. PRESSURE LOW (3P2) | 15. SEPERATE L.O. TANK LEVEL HIGH (10L2) |
| 6. E.L.O. FILTER BLOCKAGE (3P7) | 16. EMERGENCY STOP P.B. ACTUATED. (8PB1)&(8PB2) |
| 7. E.L.O. TEMPERATURE HIGH (3T2) | 17. FAULT AT ENGINE M.C.C. (RELAY AT MCC.) |
| 8. E.L.O. SUMP TANK LEVEL HIGH (3L2) | 18. SHUTDOWN VIA TRIP RELAY. |
| 9. E.L.O. SUMP TANK LEVEL LOW (3L7) | 19. SEAWATER SYSTEM OUTLET TEMP. HIGH. (6T12) |
| 10. JACKET WATER TEMP. HIGH (4T4) | 20. SPARE |

7. 15 3/4" MODULE CONTAINING:-
INDICATOR LAMPS FOR THE FOLLOWING:-

- | | |
|------------------------------|------------------------|
| 1. BARRING GEAR ENGAGED. | 11. 120 RPM ALARM ON. |
| 2. JACKET WATER PUMP ON | 12. 300 RPM ALARM ON. |
| 3. INJECTOR WATER PUMP ON. | 13. A.C. SUPPLY ON. |
| 4. LUB. OIL PRIMING PUMP ON. | 14. D.C. SUPPLY ON. |
| 5. FUEL OIL BOOSTER PUMP ON. | 15. GOVERNOR SHUTDOWN. |
| 6. ELECTRIC LINE HEATER ON. | 16. " " |
| 7. D.F.O. FUEL SELECTED | 17. " " |
| 8. R.F.O. FUEL SELECTED | 18. " " |
| 9. DFO SELECTED / FAULT. | 19. " " |
| 10. SEPERATE L.O. PUMP ON | 20. " " |
- SEE DRAWING D/ETS 2715 SH'T 4 FOR LAMP COLOURS.

8. 15 3/4" MODULE CONTAINING:-

1. DIGITAL DISPLAY PRESS. IND. 0-600psi "STARTING AIR"
2. DIGITAL DISPLAY PRESS. IND. 0-160psi "FUEL OIL" (1PS)
3. HOURS RUN COUNTER
4. ENGINE SPEED INDICATOR RANGE:- 0-600RPM. (red line 450RPM)
5. ENGINE START PUSHBUTTON
6. ENGINE STOP PUSHBUTTON
7. EMERGENCY STOP PUSHBUTTON
8. RAISE/NEUTRAL/LOWER SELECTOR SWITCH
9. C.F.O./R.F.O. FUEL SELECTOR SWITCH.
10. SPEED SWITCH. AMOT MODEL 4152.
9. 7" MODULE CONTAINING:- LOCAL / REMOTE SELECTOR SWITCH.

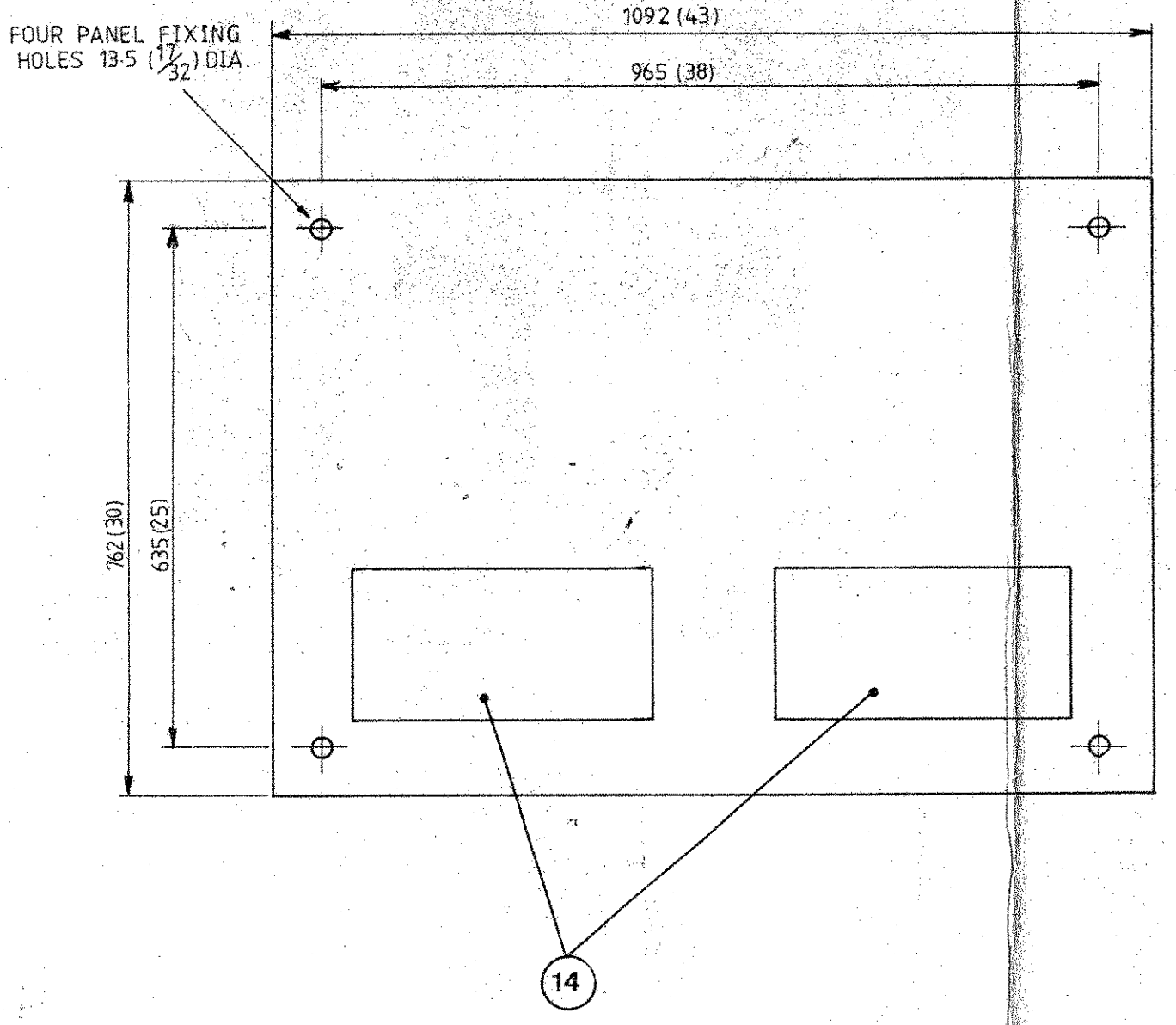

FINISH:- STOVE ENAMEL TO BS.4800 COLOUR:- **10A07** MAIN CABINET.
10A03 MODULES.
MATERIAL:- FRONT PLATES 10swg MILD STEEL
REMAINDER 14swg MILD STEEL
APPROX WEIGHT:- NETT 720 kg.

NOTE:- CABLE TRUNKING PROVIDED FOR CUSTOMERS CONNECTIONS TO INDIVIDUAL MODULES.

AMOT CONTROLS LTD. ELTON WORKS WESTERN WAY BURY ST. EDMUNDS SUFFOLK ENGLAND	TOLERANCES UNLESS OTHERWISE STATED: DIMS. IN BASIC MM. ± DIMS. TO ONE PLACE DEC. ± DIMS. TO TWO PLACE DEC. ± ANGULAR DIMS. ± RADIUS-CAST ±/MCD	MATL. — SPEC. — FINISH — SPEC. — SURFACE FINISH — REMOVE SHARP CORNERS	DRWN. P.M. FRGD.— CHKD.— APPR.— SCALE 1/8 DATE 3/11/80	TITLE INSTRUMENT ALARM AND CONTROL PANEL	MODEL (S) DRG. No. D/INS 2715
---	--	---	---	---	----------------------------------